

State of S^c Carolina Pursuant to a (22)
 warrant from John Thomas Esq^r Com^r of locations
 S^c Saluda, I have admeasured and laid
 out unto Abraham Markley a
 tract of one thousand acres of
 land, on the S^t side of Pucklat
 River, bounded S^t by Dicksons
 land, E^t by Stillwells land, and
 Saffold, W^t by old survey, Philips
 land, W^t by Pacolat River, and hath
 such shape, form & marks as the a
 bove Plat represents,
 Survey 12th May 1788, Vardry M^c Bee Esq^r.
 Recorded 12th June 1788,



State of South Carolina
 Pursuant to a warrant from John Thomas Esq^r
 Com^r of locations S^c Saluda, I have admeasured
 and laid out unto Abraham Markley a tract
 of land in 36 District on the S^t side of Enore
 River, bounded E^t by Pennel woods, S^t by Bob
 Woods, W^t by Henrywood, & by an old line the
 owner not known, and hath such shape form
 and marks as the above Plat represents,
 Survey 20th May 1788,
 Recorded 12th June 1788, Vardry M^c Bee Esq^r.



State of S^c Carolina Pursuant to a warrant from
 John Thomas Esq^r Commissioner of locations S^c Saluda
 I have admeasured and laid out unto David Allen
 a tract of five hundred & forty three acres of land in 36 Dist^r
 on the S^t side of Thickety Creek, waters of Broad River and
 on both sides of Gochers Creek, bounded S^t by
 old survey, E^t by Andersons land, W^t by Jones land
 and Thomsons Lands, S^t by Swan
 Thomsons land, N by Humphries
 land & Allens land, and hath such
 shape form and marks as the annexed
 Plat represents, Survey 9th May 1788,
 Vardry M^c Bee Esq^r.
 Recorded 12th June 1788,

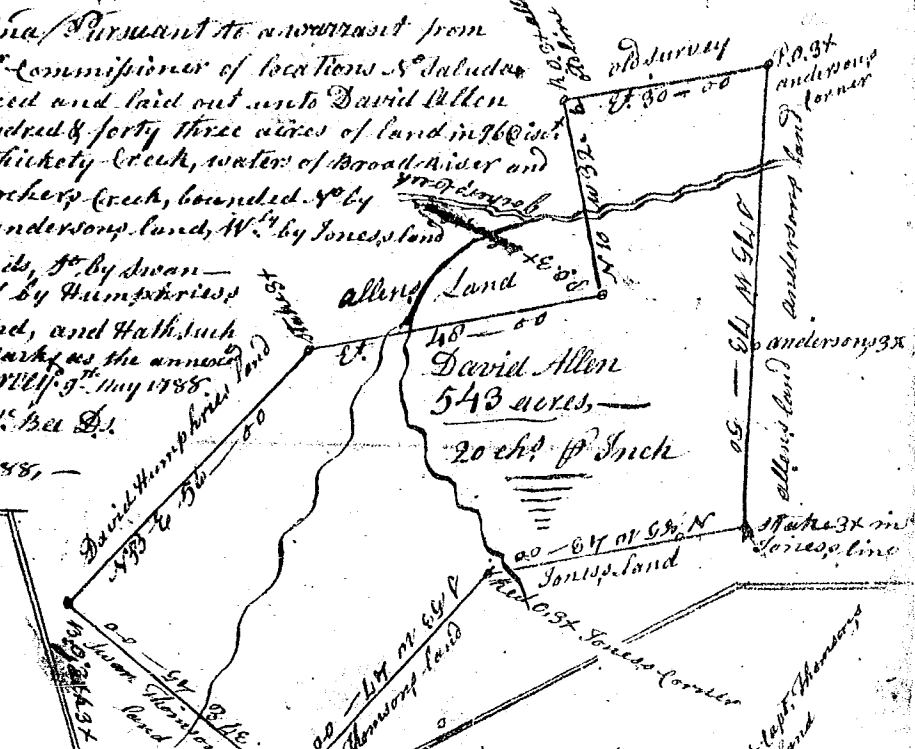

State of S^c Carolina
 Pursuant to a warrant from
 John Thomas Com^r of locations S^c Saluda, I have admeasured
 and laid out unto Rhoda M^c Bee a tract of 150 acres of
 land in 36 District, N & E. by vacant land, N & W. by lands
 of David Robertson, & Capt. John Thomsons, and hath such
 shape form & marks as the above Plat represents,
 Survey 5th May 1788, Vardry M^c Bee Esq^r.
 Recorded 12th June 1788,

